

REASSEMBLY

HINT:

- Thoroughly clean all parts to be assembled.
- Before installing the parts, apply new engine oil to all sliding and rotating surfaces.
- Replace all gaskets and oil seals with new ones.

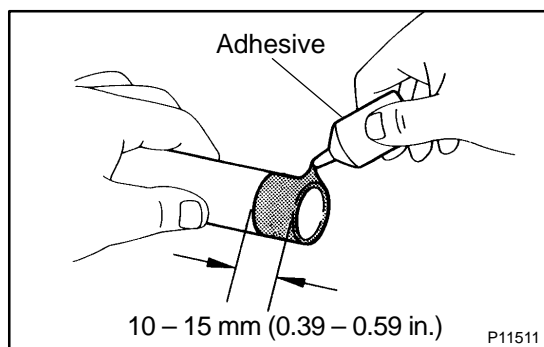

1. INSTALL SPARK PLUG TUBES

HINT:

When using a new cylinder head, spark plug tubes must be installed.

- (a) Apply adhesive to the end of the spark plug tube.

Adhesive: Part No. 08833-00070, THREE BOND 1324 or equivalent

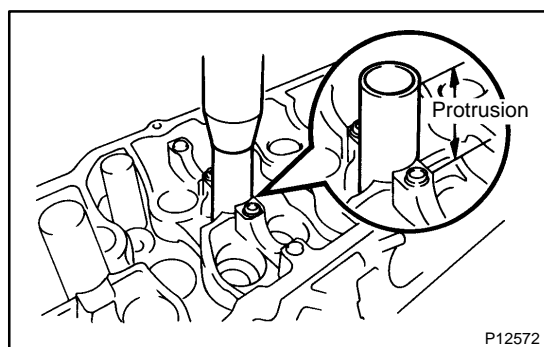

- (b) Using a press, press in a new spark plug tube until there is 42.4 – 43.4 mm (1.669 – 1.709 in.) protruding from the camshaft bearing cap installation surface of the cylinder head.

NOTICE:

Avoid pressing a new spark plug tube in too far by measuring the amount of the protrusion while pressing.

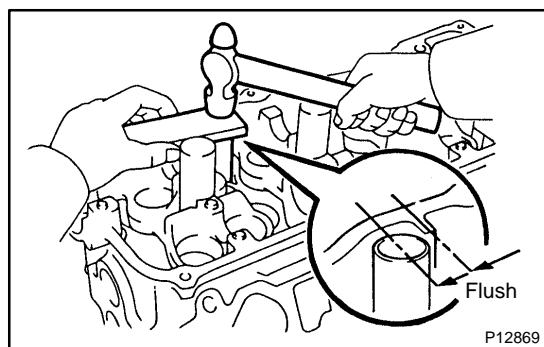

2. INSTALL PCV PIPES

HINT:

When using a new cylinder head, PCV pipe must be installed. Using a wooden block and hammer, tap in a new PCV pipe until its top side is flush with the cylinder head edge.

NOTICE:

Be careful not to damage the cylinder head edge.

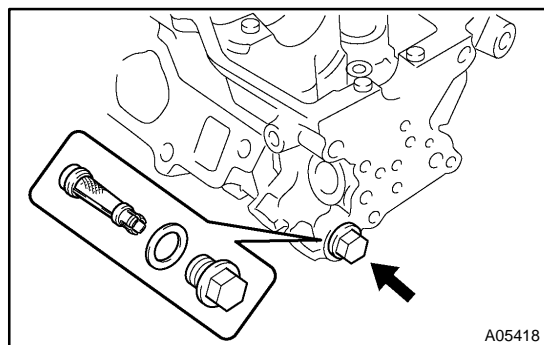

3. INSTALL OIL CONTROL VALVE FILTER

- (a) Assemble the valve filter and plug.
(b) Install the plug with new gasket.

Torque: 45 N·m (460 kgf·cm, 33 ft·lbf)

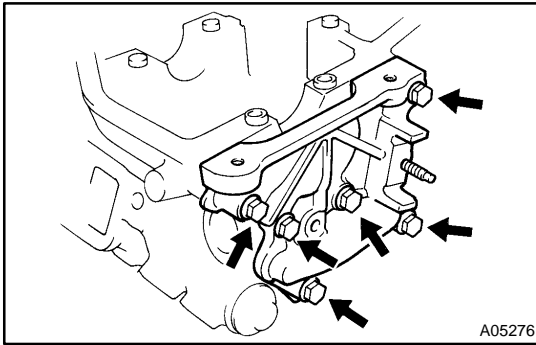

4. INSTALL CYLINDER HEAD REAR COVER

Install the rear cover and gasket with the 6 bolts.

Torque: 10 N·m (100 kgf-cm, 7.3 ft-lbf)

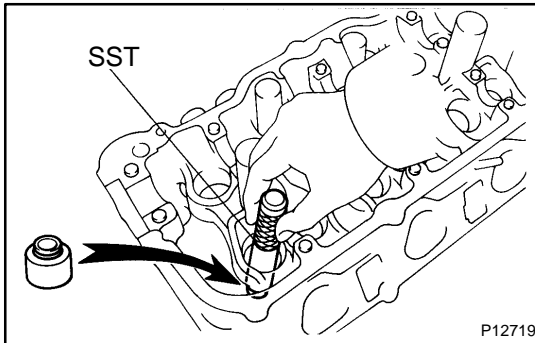

5. INSTALL VALVES

(a) Using SST, push in a new oil seal.

SST 09201-41020

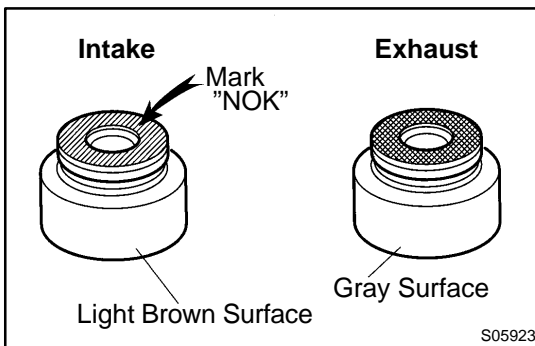

HINT:

The intake valve oil seal is light brown and the exhaust valve oil seal is gray.

NOTICE:

Pay much attention when assembling the oil seal for intake and exhaust. Assembling the wrong one may cause a failure.

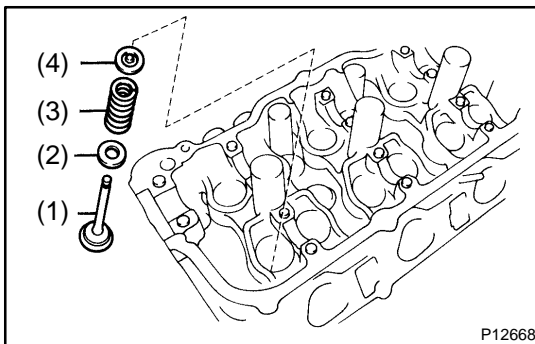

(b) Install the valve (1), spring seat (2), valve spring (3) and spring retainer (4).

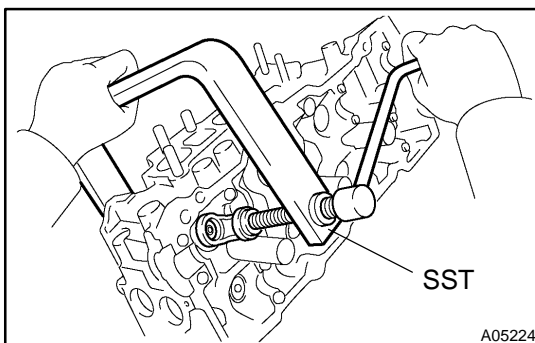

(c) Using SST, compress the valve spring and place the 2 keepers around the valve stem.

SST 09202-70020 (09202-00010)

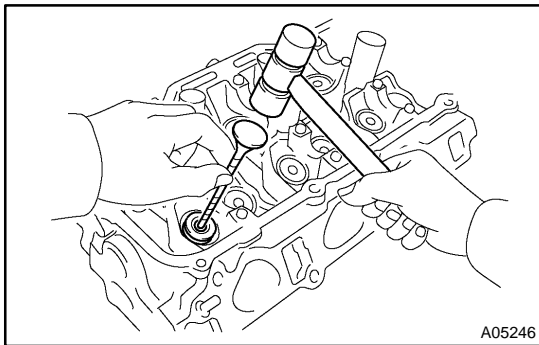

- (d) Using a plastic-faced hammer and the valve stem (not in use) tip wound with vinyl tape, lightly tap the valve stem tip to assure proper fit.

NOTICE:

Be careful not to damage the valve stem tip.

6. INSTALL VALVE LIFTERS AND SHIMS

- (a) Install the valve lifter and shim.
(b) Check that the valve lifter rotates smoothly by hand.